

OPUS

Merci

Grazie 感谢 Thank You

ありがとう Obrigado

Quick-Start Guide

Danke спасибо Gracias

The Highlights

Featuring GENOME's Pre- & Power-amp Tube-Stage Modeling™ (TSM™), our class-leading DynIR™ Engine, MIDI integration and a future-proofed USB-C specification, OPUS has been engineered to empower you with apex-level tone in a go-anywhere footprint.

- TSM™ Pre- and Power-amp simulation
- On-board DynIR™ Engine for class-leading cabinet simulation
- Pro-grade suite of essential DSP-powered processors and FX
- Pre-loaded with the OPUS-Series DynIR Cabinet Collection featuring 32 primo captures
- On-demand access to 600+ DynIRs
- Wireless and USB integration with Torpedo Remote
- GENOME OPUS Edition included

OPUS, it's more than our masterpiece: it's a back-line in your gig-bag and a macrocosm of next-level tonal excellence.



Download OPUS User Guide
opus.two-notes.com/manual



Register OPUS via Torpedo Remote
remote.two-notes.com

Warranty Information
Two notes Support
News and Products

opus.two-notes.com/warranty
support.two-notes.com
two-notes.com

2

Inputs & Outputs

- 1 Connect your Pedalboard, Guitar, **Amp output** or Line Level source here

WARNING

When using OPUS with an amplifier via the INST / LINE IN / FROM AMP input, ALWAYS ensure a suitable load box* or cabinet is connected to the TO SPEAKER output

- 2 Connect your load box* or cabinet here when plugging your amp into the INST / LINE IN / FROM AMP (1) Input
- 3 Configure OPUS' Input Level corresponding to the source connected to the INST / LINE IN / FROM AMP (1) Input
- 4 Take command of all of OPUS' editable parameters via a USB (or wireless) connection to Torpedo Remote
- 5 Power Input - 12V DC (Power Supply Included)

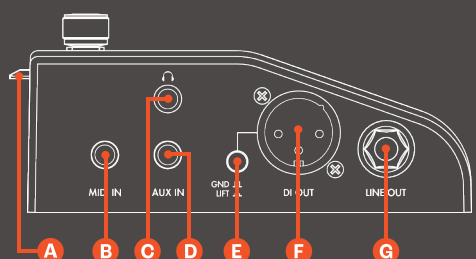
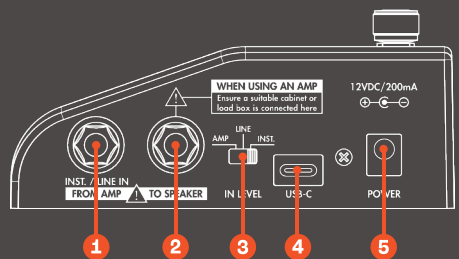

- A Memory card reader for static IR loading and storage
- B MIDI Input[†]
- C Headphone Output
- D 1/8-inch stereo Aux Input
- E Ground Lift switch
- F Balanced XLR output
- G Balanced Jack output (TRS)

* Replace your cabinet with a load box and play your tube amp silently through OPUS. For optimal performance, we recommend a reactive load box such as the Torpedo Captor. Learn more at captor.two-notes.com

[†] Learn more about MIDI settings at opus.two-notes.com/midi

3

Connectivity For Any Scenario

OPUS, Standalone

Use OPUS as a standalone tone-shaping solution, harnessing the power of the built-in TSM™ Pre- & Power-amp emulation, DynIR™ Engine, Post FX and MIDI control.

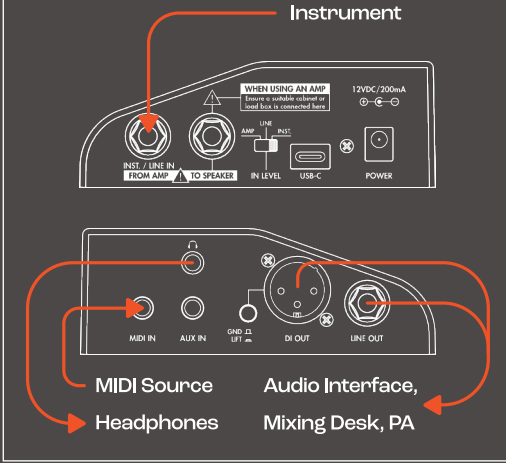

Level-Up Your Board!

Pedal fanatics, make OPUS the beating heart of your rig. Its stellar front- and rear-loading capability, in tandem with your pre- and post-amp pedal collection, delivers the ultimate 'go-anywhere' fly-rig.

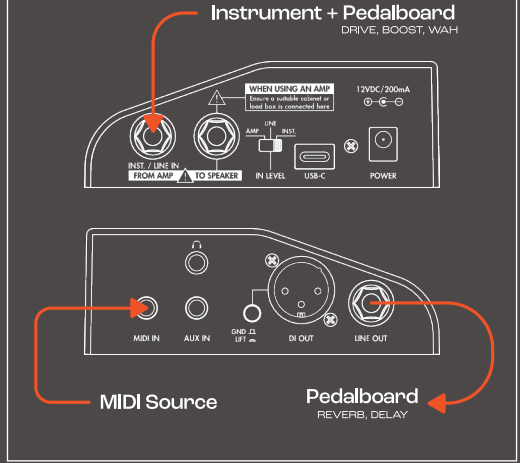

4

DI Your Amp

Place OPUS between your amp & speaker rig, engage Two notes' proprietary DynIR™ cabinet technology and deliver flawless tone to a DAW or FOH.

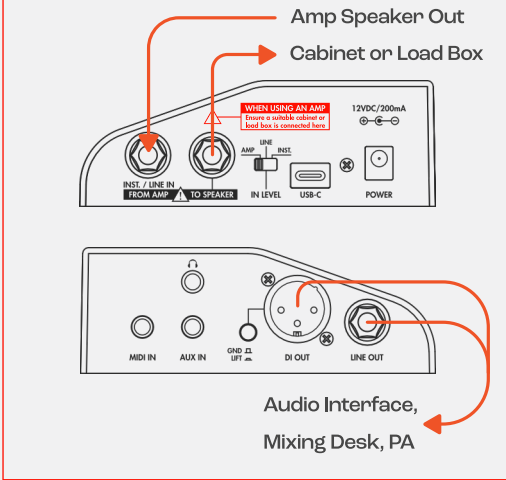

Dual Mono Routing

Send a fully-processed signal to FOH and a TSM™ Preamplifier signal to your amp's FX return, or record a dry DI and DSP processed signal using the LINE and DI outputs simultaneously.

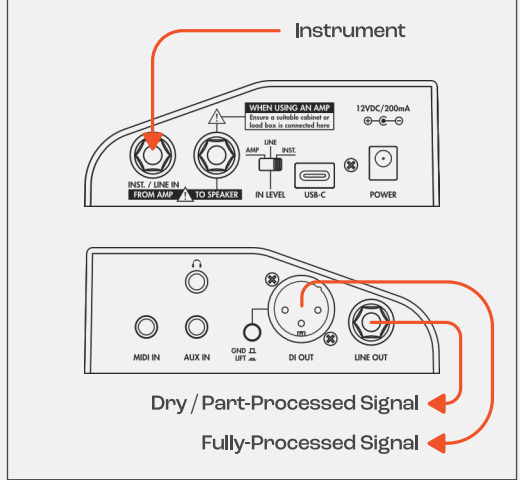

WARNING

When configuring OPUS with an amplifier via the INST / LINE IN / FROM AMP input, ALWAYS ensure a suitable load box or cabinet is connected to the TO SPEAKER output.

5

OPUS Controls

The dual rotary encoders on OPUS are continuous and both include push functionality. OPUS features two primary modes that dictate the behaviour of the rotary encoders - PERFORM Mode and MENU Mode. At startup, OPUS defaults to PERFORM Mode.

In PERFORM Mode

- The LEFT encoder lets you scroll through presets while the RIGHT encoder sets OPUS' output volume
- A short press of any encoder switches the unit into MENU Mode
- A long press on the LEFT encoder provides access to Preset naming and save options
- A long press on the RIGHT encoder activates OPUS' built-in Tuner

In MENU Mode

- The LEFT encoder can be used to navigate through OPUS' menu parameters while the RIGHT encoder lets you edit the selected parameter value
- A short press on the LEFT encoder lets you exit MENU Mode and switch back to PERFORM Mode
- A short press on the RIGHT encoder provides access to any sub-menus tied to the Main Menu options

Please note, GLOBAL ⚙️ parameters are not tied to a specific Preset and are saved directly upon instantiation; these are subsequently effective across all OPUS Presets.

Parameters outside of the GLOBAL ⚙️ parameter menu are saved at a Preset Level.

Torpedo Remote

For deft ease-of-use, Torpedo Remote (iOS/Android/MacOS/Windows) serves as the nexus of your tone shaping experience; simply hookup to your Phone, Tablet or Desktop and experience liberated 1:1 integration with every editable parameter in the OPUS architecture. **Get the download link on Page 2.**

6